

SCHEDULE "A"



J.E. ANDERSON
& ASSOCIATES
SURVEYORS - ENGINEERS

TEL: 250-758-4631 FAX: 250-758-4660
NANAIMO - VICTORIA - PARKSVILLE

SKETCH PLAN OF PROPOSED SUBDIVISION

DEC 20 2016
SUB 01335
CITY OF NANAIMO
SUBDIVISION

File: 88433

Civic: 6430 Portsmouth Road, Nanaimo, B.C.

Legal: Lot B, District Lot 28, Wellington District, Plan VP89376.

This sketch plan has been prepared in accordance with the Professional Reference Manual this 20th day of December, 2016.

Dimensions are in metres and are derived from Plan VP89376.

Subject to charges, legal notations, and interests shown on: Title No. FB453534 (P.I.D. 028-810-031)

Scale 1:250



**RENEWAL
CITY OF NANAIMO
PRELIMINARY LAYOUT
ACCEPTANCE**

~~2018-JUN-09~~ *Kris Allen*
Date Approved By
2019-JUN-13
PLAN 26689 Expiry Date

55

56

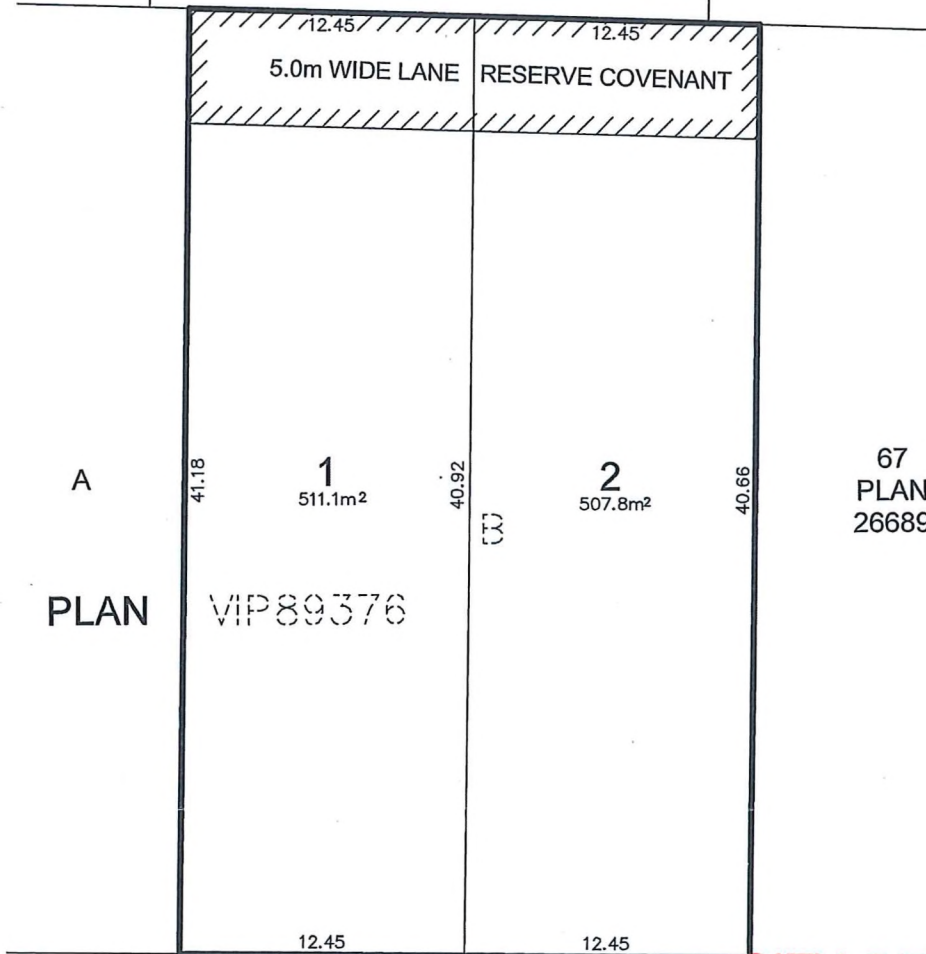

PLAN

VIP89376

67
PLAN
26689

PORTSMOUTH ROAD

**CITY OF NANAIMO
PRELIMINARY LAYOUT
ACCEPTANCE**

~~2017-JUN-13~~ *Kris Allen*
Date Approved By
2018-JUN-13
Expiry Date